



**MILLER
EVANS**

SHREWSBURY'S ESTATE AGENT

23 Red Deer Road, Shrewsbury, SY3 9FB

**£112,500 50%
Shared Ownership**

To view this property please call us on **01743 236 800** Ref: T7163/SL/KQ

An attractive and well appointed, modern, two bedroom semi-detached house.

This modern two bedroom semi-detached property is offered for sale for a 50% share of ownership. Shared ownership allows applicants to buy a share of their new home and pay rent for the remaining share. For further information on shared housing visit: www.wrekin.com

The property is situated on this conveniently placed residential development close to excellent amenities including shops, schools, frequent bus service to the town centre and within easy reach of the Shrewsbury by-pass with M54 link to the West Midlands.



FLOOR PLANS

Ground Floor
Approx. 306.8 sq. feet

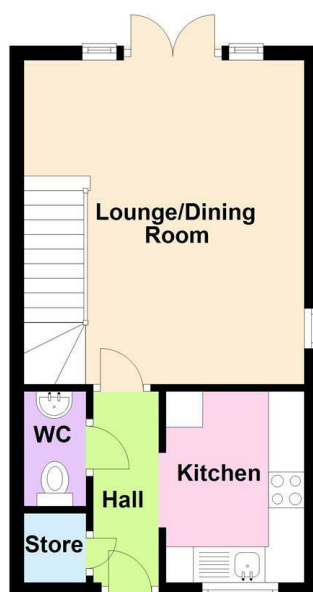

First Floor
Approx. 306.8 sq. feet

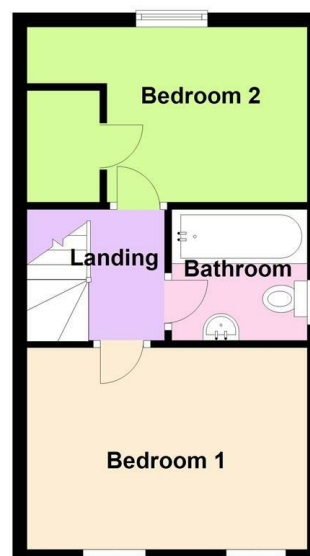

Total area: approx. 613.6 sq. feet

Illustration For Identification Purposes Only. Not To Scale.
Plan produced using PlanUp.

INSIDE THE PROPERTY

ENTRANCE HALL

Built in cloaks cupboard

CLOAKROOM

Wash hand basin, wc

LOUNGE / DINING ROOM

14'10" x 12'10" (4.52m x 3.91m)

A pleasant room with glazed French doors to the rear

KITCHEN

8'9" x 6'4" (2.67m x 1.93m)

Neatly appointed and fitted with a range of matching modern units

STAIRCASE rising to FIRST FLOOR LANDING

BEDROOM 1

9'3" x 12'10" (2.82m x 3.91m)

BEDROOM 2

8'0" x 12'10" (2.44m x 3.91m)

BATHROOM

Neatly appointed with a modern panelled bath with shower
Wash hand basin, wc

OUTSIDE THE PROPERTY

Ample parking space with a shallow forecourt to the front

There is a good sized enclosed REAR GARDEN with a paved patio, neatly kept lawn. The whole enjoying a sunny south westerly aspect.



HOW TO FIND THIS PROPERTY

The property is best approached out of Shrewsbury along Radbrook Road. Continue to the second mini-island, turning right into Red Deer Road. Continue for some distance and the property will be found on the left hand side.



HOW ENERGY EFFICIENT IS THIS PROPERTY?

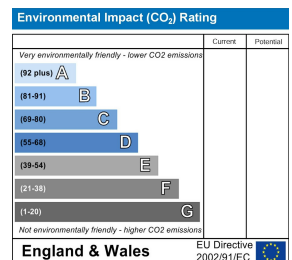
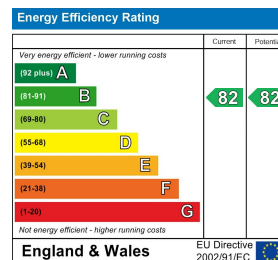

SERVICES

We understand that mains water, electricity, drainage and natural gas are connected

TENURE

We are advised that this property is Leasehold and this will be confirmed by the vendors' solicitors during pre-contract enquiries

LOCAL AUTHORITIES

Shropshire Council
Shirehall, Abbey Foregate, Shrewsbury SY2 6ND
Tel: 0345 678 9000

Miller Evans is fully committed to implementing the GDPR 2018 and the Money Laundering Regulations 2017 and will at all times ensure that your personal data is held in strict accordance with the law.

IMPORTANT NOTICE

Our particulars have been prepared with care and are checked where possible by the vendor. They are however, intended as a guide. Measurements, areas and distances are approximate. Appliances, plumbing, heating and electrical fittings are noted, but not tested. Legal matters including Rights of Way, Covenants, Easements, Wayleaves and Planning matters have not been verified and should take advice from your legal representatives and Surveyor.

DO YOU HAVE A PROPERTY TO SELL?

We will always be pleased to give you a no obligation market assessment of your existing property to help you with your decision to move.

FIND OUR PROPERTIES ON:



Residential Sales & Lettings
Eagle House, 4 Barker Street,
Shrewsbury SY1 1QJ
Tel: 01743 236800

South Shropshire Sales Office
4 The Square,
Church Stretton SY6 6DA
Tel: 01694 724700



www.millerevans.co.uk | homes@millerevans.co.uk

Members of: National Association of Estate Agents • Guild of Property Professionals • National Federation of Property Professionals • Fine & Country

Partners: David S. Miller (FNAEA) Proprietor • Stuart Langley (FNAEA)

Associates: Georgie H. Miller BSc(Hons) • Sharon L. Langley (MARLA) **Consultant:** David C. Evans **Fine & Country:** Emma Romaine-Jones